



Camberwell Grove, SE5 | £290,000

02087028222

[eastdulwich@pedderproperty.com](mailto:eastdulwich@pedderproperty.com)

**pedder**  
We live local



# In General

# In Detail

CHAIN FREE - Charming and characterful top-floor studio apartment on this highly-desirable tree-lined street between Camberwell and Peckham Rye.

Camberwell Grove is enviably located for the excellent transport links into The City and West End from Peckham Rye station Denmark Hill station (0.3 miles) and Peckham Rye station (0.8 miles) as well as bus/cycle routes through the neighbouring East Dulwich, Herne Hill and Brixton. There are a host of independent shops, bars, restaurants and coffee shops on nearby Lordship Lane, Bellenden Road and Grove Lane – as well as a choice of parks and green spaces.

Boasting over 430 Sq Ft as part of this imposing Grade II listed Georgian Building – there is a beautifully bright and well-appointed kitchen to the rear of the property and a full bathroom. To the front of the property is the bedroom/living area complete with high ceilings and gorgeous windows.

Having been recently let – there is some gentle modernisation needed in places – but this would suit a first-time buyer looking for easy access into town.

EPC: E | Council tax band: B | Lease: 151 years remaining | SC: £1,103 pa | GR: £100 pa | BI: incl. in SC



# Floorplan

## Camberwell Grove, SE5

Approximate Gross Internal Area  
40.9 sq m / 440 sq ft

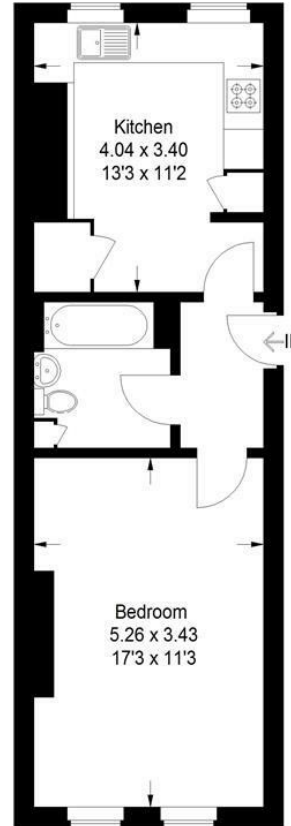

### Third Floor

Copyright www.pedderproperty.com © 2024  
These plans are for representation purposes only as defined by RICS - Code of Measuring Practice. Not drawn to Scale. Windows and door openings are approximate. Please check all dimensions, shapes and compass bearings before making any decisions reliant upon them.

Energy Efficiency Rating	
Very energy efficient - lower running costs	Current
102 plus) A	84
81-101) B	
69-80) C	
55-68) D	
39-54) E	
21-38) F	
1-20) G	
Not energy efficient - higher running costs	45
England & Wales	EU Directive 2002/91/EC

Pedder Property Ltd trading as Pedder for themselves and for the vendor/landlord of this property whose agents they are, give notice that (1) these particulars do not constitute any part of an offer or contract, (2) all statements contained within these particulars are made without responsibility on the part of Pedder or the vendor/landlord, (3) whilst made in good faith, none of the statements contained within these particulars are to be relied upon as a statement of representation or fact, (4) any intending purchaser/tenant must satisfy him/herself by inspection or otherwise as to the correctness of each of the statements contained within these particulars, (5) the vendor/landlord does not make or give either Pedder or any person in their employment any authority to make or give representation or warranty whatsoever in relation to this property.